

# VYR-50 AG



## VYR-50 AG · Full Circle AG

### GENERAL PROPERTIES:

- 1/2" male connection.
- Made of brass and stainless steel.
- High-resistance rotating joints.
- Adjustable deflector plate.
- Irrigation area control system by adjustment of rotating clips.
- Adjustable jet breaker diffuser pin.
- This sprinkler is strong and durable enough to work for years in urban gardens in punishing conditions, such as vandalism and impact from maintenance equipment.

### TECHNICAL SPECIFICATIONS:

- Range distance: 9 - 14 m / 30-46 ft.
- Flow: 240 - 1440 L/H / 63 - 380 GPH
- Working pressure: 1 - 4 BAR / 14 - 58 PSI.
- Area: Full or part circle.
- Nozzles: A single-jet nozzle.
- Trajectory angles: 28°
- Maximum stream height: 2,6 m / 8,5 ft.
- Rotation time: Depending on the pressure and the nozzles, the rotation will be constant and continuous.
- Uniformity coefficient higher than 90% in areas of 10x10R, 12x12T and 12x13T (meters).

### APPLICATIONS:

- Public and private gardens.
- Horticultural plantations, floriculture and fruit trees.

### MEASUREMENTS:

- Height: 13 cm / 5,1 in.
- Width: 12 cm / 4,7 in.
- Weight: 220 g / 0,50 Lbs
- Units per box: 50

### OPTIONS:

- Threads in BSP or NPT under demand.
- Special design with a threaded shaft for fitting to the VYR-961 pop-up head.
- Self-compensating flow control valves of 1.5 and 2 BAR
- Assembled on "Agro-Stand" with a 1.3 m galvanized steel spike, microtube and connectors.
- Assembled on a brass, aluminium or plastic spike.
- Assembled on an aluminium round base.

### MODELS:

- Ref. 005001: Full circle sprinkler + Deflector + Difuser pin
- Ref. 005002: Full circle sprinkler + Difuser pin
- Ref. 005003: Full circle (without deflector or pin)

## TABLES & PARTS

### Technical guidance table VYR-50 AG

NOZZLE	Spacing (m) / Precipit. rate (mm/h) Spacing (ft) / Precipit. rate (in/h)						
	BAR PSI	9x9 30x30	9x9 T 30x30 T	9x10 33x33	10x10 T 33x33 T	10x12 T 33x39 T	12x12 T 39x39 T
3,6 mm 9/64"	2,5	9,7	9,0	7,6	7,3	6,6	5,5
	36	0,38	0,35	0,31	0,28	0,21	0,20
	3	10,6	9,8	8,3	8,0	7,2	6,0
4 mm 5/32"	44	0,41	0,38	0,33	0,31	0,23	0,21
	3,5	11,5	10,6	8,9	8,6	7,8	6,5
	5	0,44	0,41	0,36	0,33	0,25	0,23
4,4 mm 11/64"	2,5	12,0	11,1	9,3	9,0	8,1	6,8
	36	0,46	0,43	0,38	0,35	0,26	0,24
	3	13,1	12,1	10,2	9,8	8,9	7,4
4,4 mm 11/64"	44	0,51	0,47	0,41	0,38	0,28	0,26
	3,5	14,2	13,1	11,0	10,6	9,6	8,0
	5	0,55	0,51	0,44	0,41	0,30	0,29
4,4 mm 11/64"	2,5	14,5	13,4	11,3	10,9	9,8	8,2
	36	0,56	0,52	0,46	0,42	0,31	0,29
	3	15,9	14,7	12,4	11,9	10,7	8,9
4,4 mm 11/64"	44	0,62	0,57	0,50	0,46	0,34	0,32
	3,5	17,2	15,9	13,4	12,8	11,6	9,7
	5	0,67	0,6	0,54	0,50	0,37	0,35

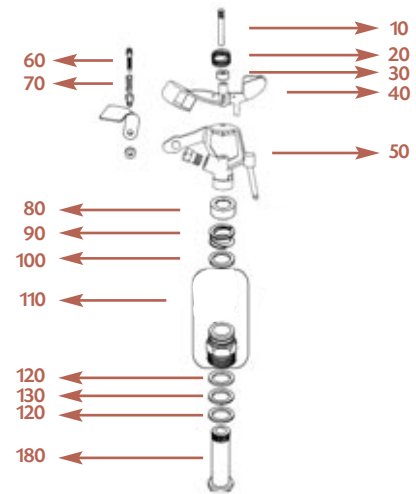

T: Triang. CU < 85% CU 85-88% CU 88-92% CU > 92%

### Performance nozzle table VYR-50 AG

NOZZLE	2,4 mm 3/32"		2,8 mm 7/64"		3 mm 1/8"		3,2 mm 17/128"		3,6 mm 9/64"		4 mm 5/32"		4,4 mm 11/64"	
	BAR PSI	L/H GPH	Ø m Ø ft	L/H GPH	Ø m Ø ft	L/H GPH	Ø m Ø ft	L/H GPH	Ø m Ø ft	L/H GPH	Ø m Ø ft	L/H GPH	Ø m Ø ft	L/H GPH
1	240	18	310	19	360	19	400	20	480	20	620	21	760	22
15	63	59	82	62	95	62	106	66	127	66	164	69	201	72
1,5	300	19	370	19	440	20	480	21	570	21	750	22	910	23
22	79	62	98	62	116	66	127	69	150	69	198	72	240	75
2	340	20	420	20	500	21	550	21	660	22	850	23	1030	24
29	90	66	111	66	132	69	145	69	174	72	224	75	272	79
2,5	380	21	470	21	560	22	600	22	730	23	950	24	1150	25
36	100	69	124	69	148	72	158	72	193	75	251	79	304	82
3	410	22	520	22	610	23	660	23	800	23	1040	24	1270	25
44	108	72	137	72	161	75	174	75	211	75	275	79	335	82
3,5	450	23	560	23	650	23	710	23	860	24	1100	25	1350	26
5	119	75	148	75	172	75	187	75	227	79	290	82	356	85
4	480	24	600	24	690	24	760	24	910	25	1180	26	1440	27
58	127	79	158	79	182	79	201	79	240	82	312	85	380	89

Standard Ø: Diameter range

- For optimum distribution avoid use in shady areas. Only with deflector plate!!!
- Sprinklers will be supplied with standard nozzles unless otherwise specified.
- These results has been obtained at indoor laboratory with 0 m/seg win velocity. Outdoor results may change range distances.

